

## Wall framing

This section on wall framing uses the example house plan introduced in earlier sections. For worked examples the wall framing timber will be F5 dressed, seasoned pine. Many other timber species and stress grades could be used for this frame, but F5 pine has been chosen as a common example.

### Terms applying to wall and ceiling framing

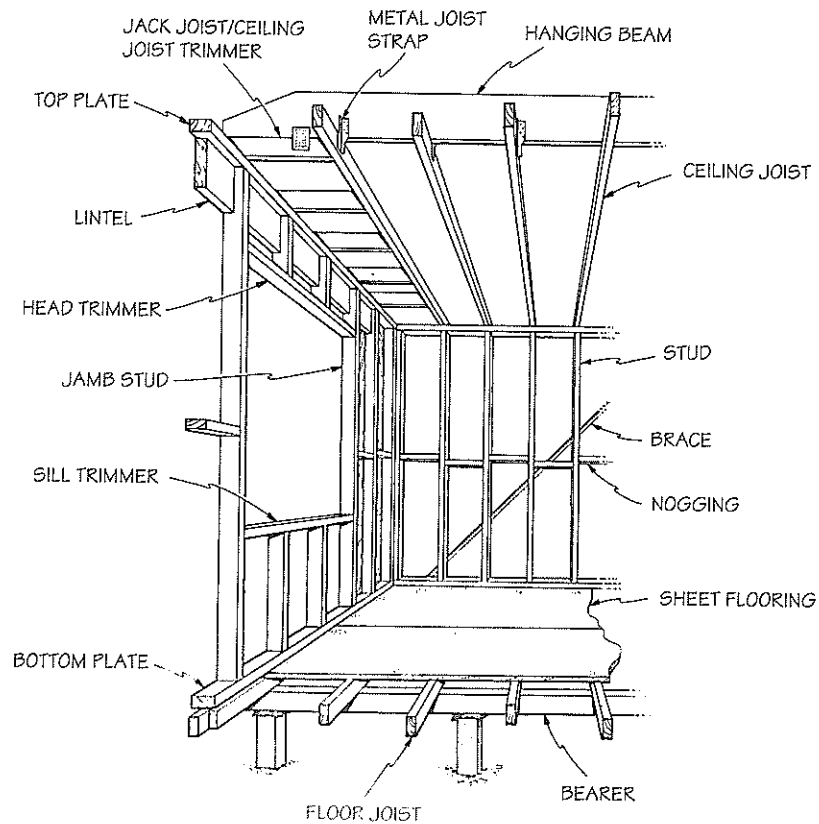

### Setting out wall positions on the floor

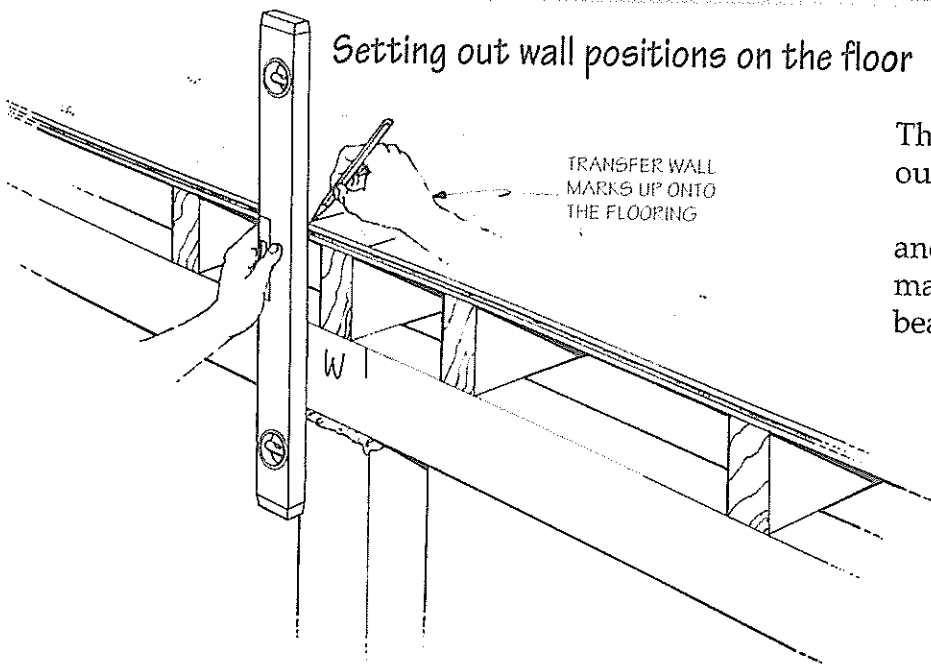

The walls can now be set out on the platform floor.

Start by using a level and transferring the wall marks on the outside bearers up onto the floor.